

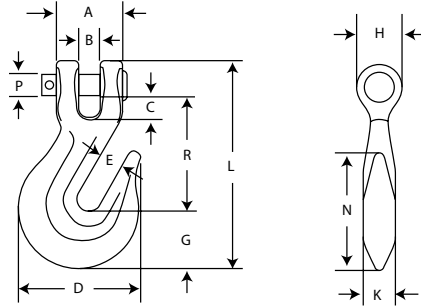

Dimensions / Dimensions



Size Taille (in./ po.)	A (in./ po.)	B (in./ po.)	C (in./ po.)	D (in./ po.)	E (in./ po.)	G (in./ po.)	H (in./ po.)	K (in./ po.)	L (in./ po.)	N (in./ po.)	P (in./ po.)	R (in./ po.)
1/4	1.00	0.32	0.31	1.81	0.34	0.88	0.72	0.47	3.05	1.75	0.31	1.64
5/16	1.22	0.43	0.36	2.12	0.44	0.44	0.9	0.59	3.66	2.06	0.38	2.02
3/8	1.42	0.48	0.49	2.53	0.50	0.50	1.00	0.72	4.42	2.34	0.44	2.41
7/16	1.66	0.66	0.62	3.09	0.56	0.56	1.13	0.69	4.94	2.66	0.56	2.75
1/2	1.88	0.57	0.51	3.56	0.66	0.66	1.25	0.78	5.72	2.97	0.63	3.19