

AVENTOS HS top

Up, Over and Out of the Way

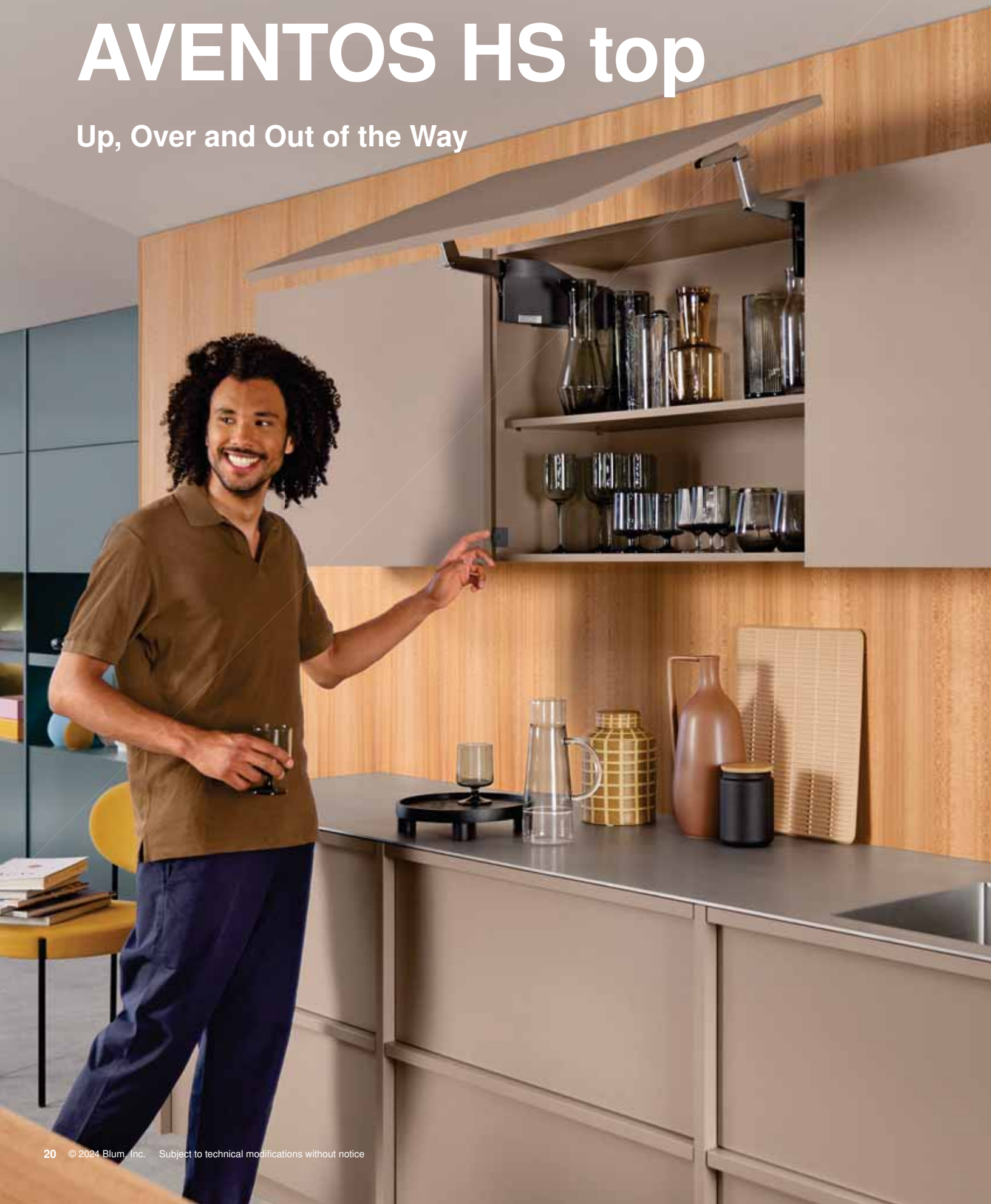

Ordering Information

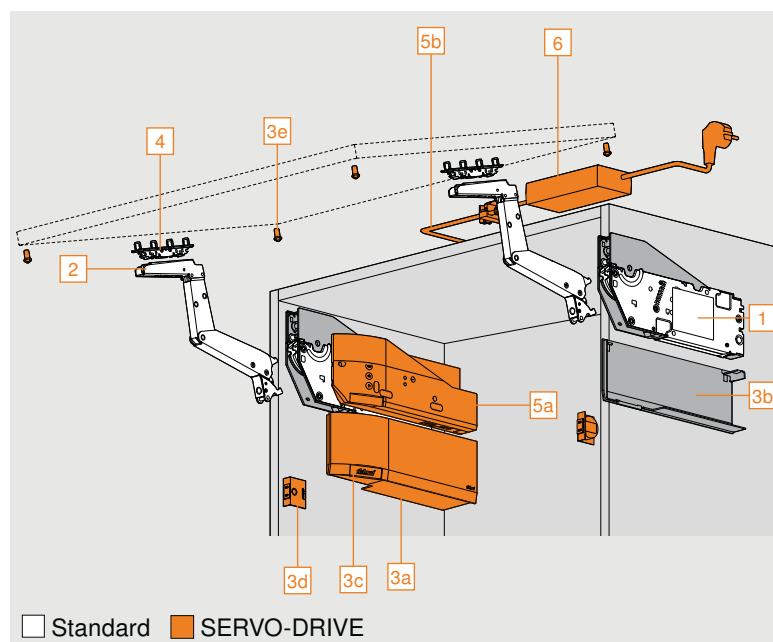

- Ideal for large, one-part doors
- Cabinet height **350** (13-3/4") to **800** (31-1/2")
- Cabinet width up to **1828** (72")
- Inside depth of at least **264** (10-3/8")
- Integrated BLUMOTION for soft and effortless closing
- Light operating forces
- Variable stop
- Fixed position of the lift mechanism and door mounting plate
- Symmetrical levers
- Tool-free assembly
- Two lift mechanism fixing methods
- 3-dimensional adjustment of the door

Note

We recommend the more powerful lift mechanism for applications in overlapping ranges.
A trial application is recommended when you are in a borderline area of the individual lift mechanism's power factor range.

The power factor can be increased by 50% when using a third lift mechanism.
We recommend a third lift mechanism for wide cabinets. This will prevent the door from sagging when open.

Lift mechanism set ☐ ☒

Fixing with wood screws and positioning system

1		Set includes: <ul style="list-style-type: none"> – Symmetrical lift mechanism with positioning system (qty 2) – Wood screws Ø4 x 35 (qty 8) 			
			Cabinet height	Door weight (lb/oz)	Part no.
			350 (13-3/4")–450 (17-5/8")	4/6–25/5	22S2200
			450 (17-5/8")–540 (21-1/4")	5/8–27/9	22S2500
			480 (18-7/8")–660 (25-7/8")	6/1–33/10	22S2800
			650 (25-1/2")–800 (31-3/8")	7/11–40/13	22S2810

Lift mechanism set ☐ ☒

Fixing with pre-attached system screws

1		Set includes: <ul style="list-style-type: none"> – Symmetrical lift mechanism with pre-attached system screws (qty 2) 			
			Cabinet height	Door weight (lb/oz)	Part no.
			350 (13-3/4")–450 (17-5/8")	4/6–25/5	22S2210
			450 (17-5/8")–540 (21-1/4")	5/8–27/9	22S2510
			480 (18-7/8")–660 (25-7/8")	6/1–33/10	22S2810
			650 (25-1/2")–800 (31-3/8")	7/11–40/13	22S2810

Ordering Information

Lever set <input type="checkbox"/> <input checked="" type="checkbox"/>		
<div>2</div> 	Set includes: <ul style="list-style-type: none"> Symmetrical levers (qty 2) 	Part no.
	Symmetrical lever set	22S3500

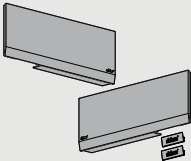

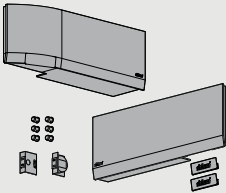
Cover cap set <input type="checkbox"/>		
<div>3</div> 	Set includes: <ul style="list-style-type: none"> - Cover cap left 3b Cover cap right 3c Stainless steel branding element – Blum logo (qty 2) 	Specify color when ordering:
		<div> <input checked="" type="checkbox"/> Dark gray (TGR) <input type="checkbox"/> Silk white (SW) <input type="checkbox"/> Light gray (HGR) </div> <div>Part no.</div>
Cover cap set		22.8000.NA

Cover cap set for SERVO-DRIVE <input checked="" type="checkbox"/>		
<div>3</div> 	Set includes: <ul style="list-style-type: none"> 3a SERVO-DRIVE cover cap left (qty 1) 3b Cover cap right (qty 1) 3c Stainless steel branding element – Blum logo (qty 2) 3d SERVO-DRIVE switch (qty 2) 3e Blum distance bumper Ø5 (qty 6) 	Specify color when ordering:
		<div> <input checked="" type="checkbox"/> Dark gray (TGR) <input type="checkbox"/> Silk white (SW) <input type="checkbox"/> Light gray (HGR) </div> <div>Part no.</div>
Cover cap set for SERVO-DRIVE		23.8000.NA

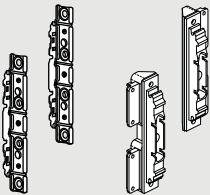

Branding element (optional) <input type="checkbox"/> <input checked="" type="checkbox"/>		
<div>3c</div> 	Specify color when ordering dark gray (TGR) or silk white matte (SW-M)	
	<div> <input checked="" type="checkbox"/> Dark gray (TGR) <input type="checkbox"/> Silk white matte (SW-M) <input type="checkbox"/> Stainless steel (IN-G) </div>	
		<div> <div>SW-M, TGR</div> <div>IN-G</div> </div>
Printed* (qty 2)		ABD.1000.BL ABD.1009.BL
Embossed* (qty 2)		ABD.1000.BT ABD.1009.BT
Plain (qty 2)		ABD.1000 ABD.1009

*Branding element is printed or embossed with Blum logo

Customized branding element
Printed: 1000 pc minimum
Embossed: 5000 pc minimum

Door hardware set <input type="checkbox"/> <input checked="" type="checkbox"/>		
<div>4</div> 	<ul style="list-style-type: none"> Use 4 wood screws (606N or 606P) per side for wooden doors. Use 4 (included) countersunk self-tapping screws (660.0950) per side for wide aluminum frames. 	Part no.
	Wooden doors and wide aluminum frames	20S4200
Narrow aluminum frames		20S4200A
Large overlay 5-piece doors		20S4F01
EXPANDO T door mounting plate		
	<ul style="list-style-type: none"> EXPANDO T suitable for thin fronts – see page 63 Thin fronts (qty 2) 	Part no.
	EXPANDO T door mounting plate	20S42T1

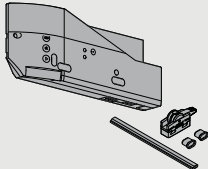
Ordering Information

SERVO-DRIVE set 			
<div>5</div> 	Set includes:		
	5a	SERVO-DRIVE drive unit (qty 1)	<div>NOTE: For three lift mechanisms or more, we recommend two synchronized drive units</div> <div> Dust gray (R7037)</div> <div>Part no.</div>
	5b	SERVO-DRIVE distribution cable, 1500 (qty 1)	
	-	Connecting node (qty 1)	
	-	Cable end protector (qty 2)	
SERVO-DRIVE set			23.A000

SERVO-DRIVE power supply unit and accessories	
6	See page 66 for complete ordering information

Planning

Space requirement

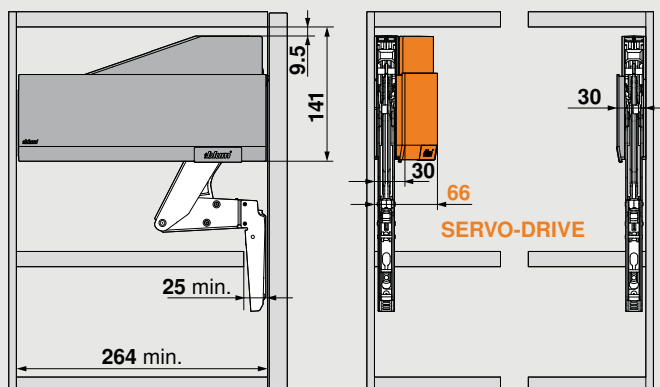

Door protrusion for common cabinet heights

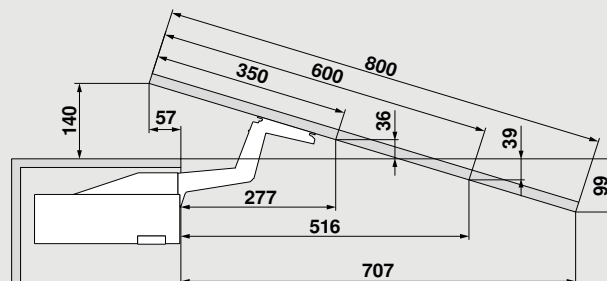

Dimensions depend on tilt adjustment

Lift installation with positioning system (no pre-drilling required)

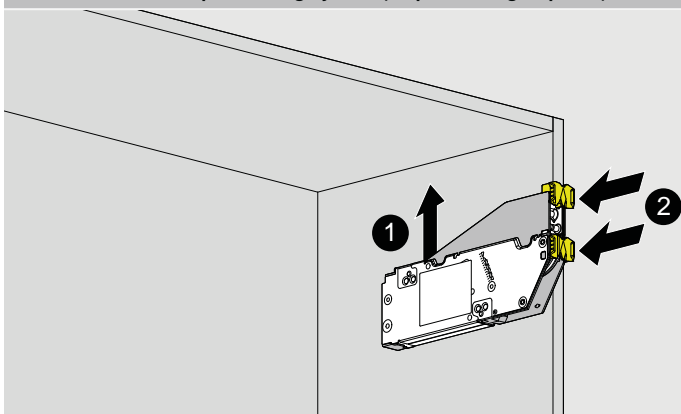

4 x wood screws Ø4 x 35

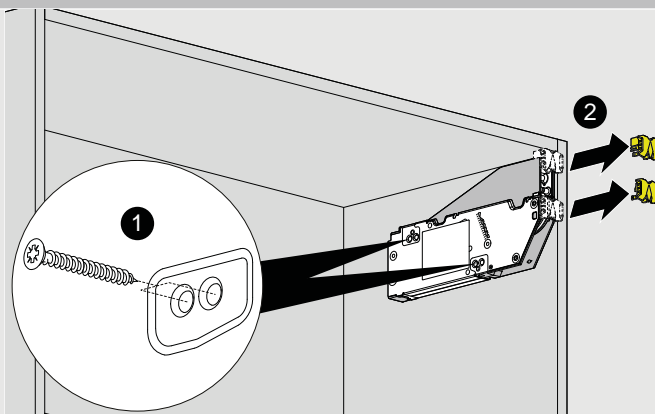

Lift installation with system screws

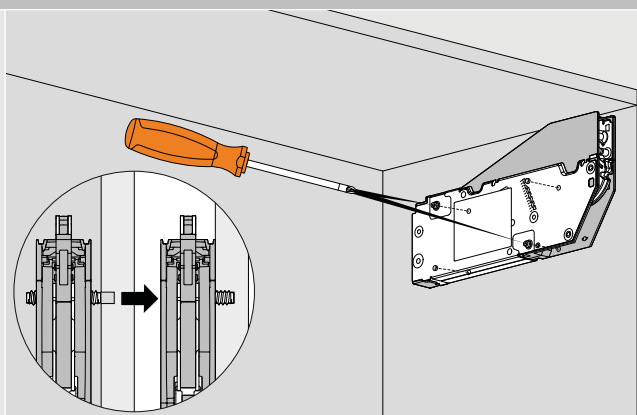
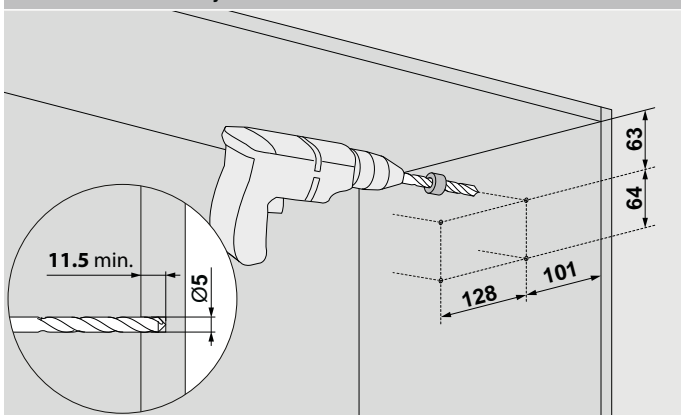

Face frame application

See page 62 for information on face frame mounting brackets.

Planning

Door Assembly

Wooden doors and wide aluminum frames

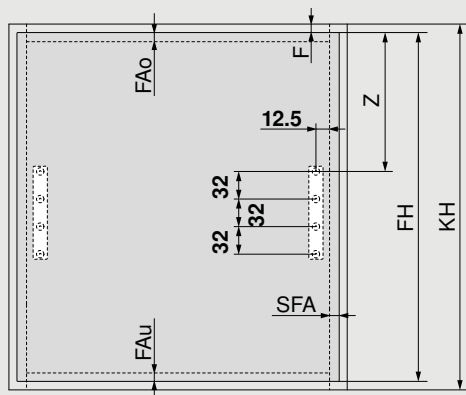

FAo = Upper door overlay

FAu = Bottom door overlay

F = Gap

Z = 195 + FAo

FH = Door height

KH = Cabinet height

SFA = Side door overlay

Narrow aluminum frames

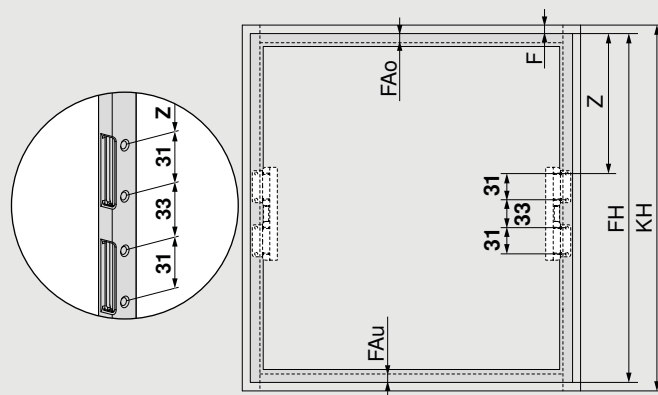

FAo = Upper door overlay

FAu = Bottom door overlay

F = Gap

Z = 195.5 + FAo

FH = Door height

KH = Cabinet height

Space requirement – cornice | crown molding

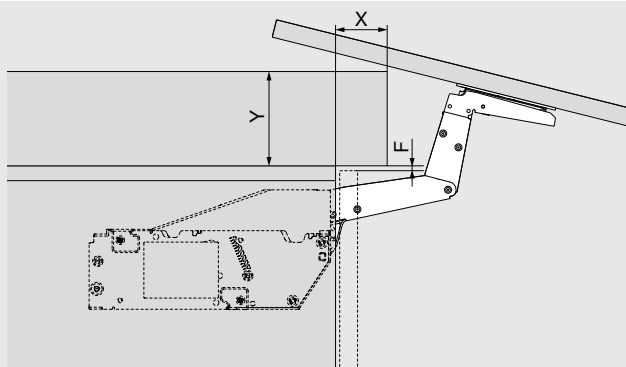

F	3.0	2.0	1.5
X maximum	31	29	27
Y maximum	117	118	119

F = Gap

Installation and Adjustment Instructions

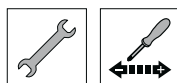
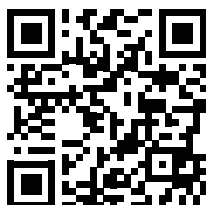

Use QR code or link below for AVENTOS HS top installation and adjustment instructions

www.blum.com/hstopassembly

Planning

SERVO-DRIVE for AVENTOS HS top

Blum distance bumper (SERVO-DRIVE application only)

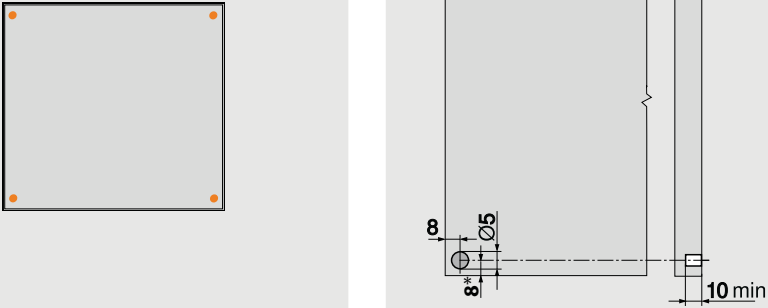

Insert Blum distance bumper (do not glue)

Recommendation for aluminum frames

Consider drilling the Blum distance bumper in the cabinet side

A trial application must be carried out when fixing to the door

*From cabinet bottom edge for doors that protrude below

NOTE: The distance bumper should not touch the SERVO-DRIVE switch

SERVO-DRIVE switch

