

BASE CABINET PULL-OUT

Always read the instructions carefully and completely before beginning assembly.
Remove and check contents for damage and/or missing parts.

Box Contents: 1 pc . Base Cabinet Pull-Out
2 pc. Adjustable Bumper Kits
4 pc. Door Mount Bracket Sets
4 pc. #8 x 1-1/8" Wood Screws

You will need:
Safety Glasses
Tape Measure
Screw Driver
Wood Screws for Door Mount



Installation Instructions

STEP 1- Remove door from cabinet .

STEP 2- Remove Pull-Out from Mounting Board by pulling the Front Locking Device levers inward. Locate Mounting Board on Cabinet's floor. Center side to side while front edge is against the Cabinet's face frame (3/4" back for frameless Cabinets). Secure with four #8x1-1/8" wood screws through the base of the unit into the floor of the cabinet. Be sure to drive screws near the four corners, but allow enough room back to clear the cabinet's kick space . See Fig.1 (IMPORTANT: Do not allow the Pull Out Unit to protrude past the cabinet's face frame or Door will not close properly).

STEP 3- Install Adjustable Bumper Kits to both sides of Face Frame, 25-1/2" up from bottom edge. After installation is complete, adjust the knobs by turning until the surface is approximately 1/16" from Pull-Out rails. See Fig.2

STEP 4- Attach Door Mount Brackets to front panel. Insert Bracket Fasteners through long Slots in Brackets into the slots in the front panel. Secure with Machine Screws supplied. Do not fully tighten. See Fig.3

STEP 5- Attach cabinet door to Base Cabinet Pull-Out. See Fig.4 * HELPFUL HINT-Place 4 pads of double sided tape onto Pull-out. With unit closed, align Cabinet door as desired and press against tape. Remove unit and attach Cabinet Door to Pull-out using 4 wood screws (Not included) . (IMPORTANT! Use caution on your fastener length to avoid protrusion thru door face). Fully tighten Door Mount Brackets after satisfactory Door placement is achieved.

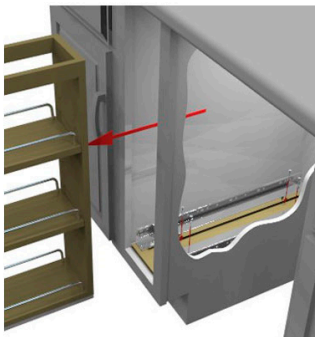

Fig.1

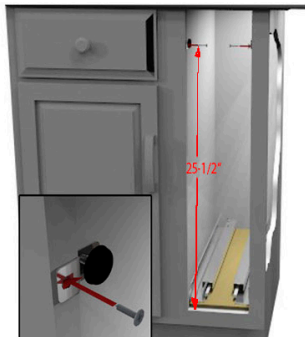

Fig.2

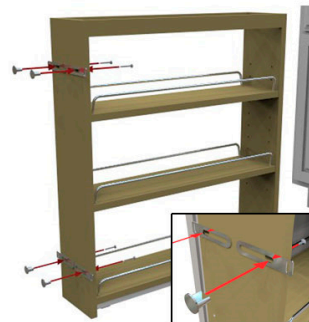

Fig.3

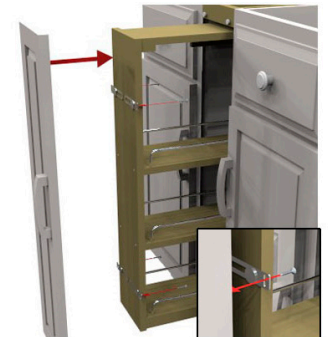

Fig.4